

## GalvinAssist® CP Lead Safe™ Wall Top Assembly

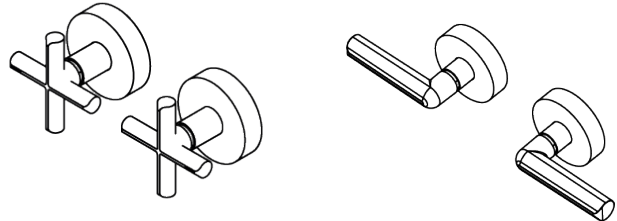

### PRODUCT CODES:

- 110.30.00.03 - GalvinAssist® CP Lead Safe™ Cross Wall Top Assembly with 3/4 Turn  
110.31.00.03 - GalvinAssist® CP Lead Safe™ Lever Wall Top Assembly with 1/4 Turn

### SPECIFICATIONS

- Chrome plate for easy cleaning and durability.
- Simple servicing and readily available parts.
- Quality controlled. Every tap is tested.
- Lead Safe™ brass construction\*.

#### IMPORTANT:

\*Our Lead Safe™ product range is compliant with the Lead Free Requirements of the NCC 2022 Vol. Three, Clause A5G4(2) and NSF/ASNI 372.  
\*\* Any flow controller incorporated in the outlet to be tightened to prevent removal by hand. As Per AS3718

**WARNINGS:** Special attentions to be paid on notes, photos, images, or drawings of assembly steps marked with the warning symbol.



## TECHNICAL DATA

Inlet		5/8" BSP - Male
Outlet		N/A
Headworks		Ceramic Disc
Working Pressure Range (kPa)	Min	150
	Max	500
Working Temperature Range (°C)	Min	5
	Max	60
Nominal Flow Rate (LPM)		N/A
Construction		Lead Free Brass
Finish		Chrome
NOTE: Galvin Engineering continually strive to improve their products. Specifications may change without notice		

## TOOLS REQUIRED

- Spanner or adjustable crescent.

## PRE-INSTALLATION

- Before installation, all lines must be flushed.
- Galvin Engineering recommends the installation of strainers and pressure reducing valves (when necessary) to ensure clean consistent supply. Debris or poor water quality could affect the performance of the unit.

## DIMENSIONS

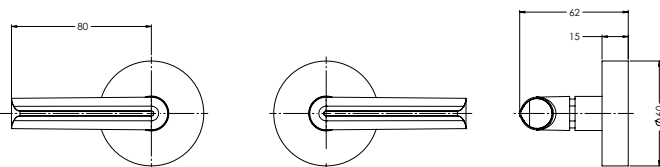

110.31.00.03  
**Lever Wall Top Assembly with 1/4 Turn**

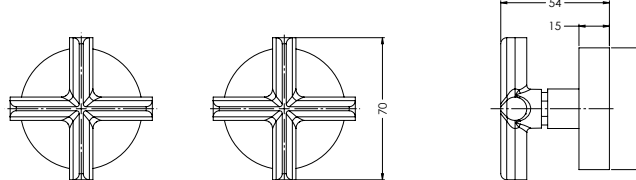

110.30.00.03  
**Cross Wall Top Assembly with 3/4 Turn**

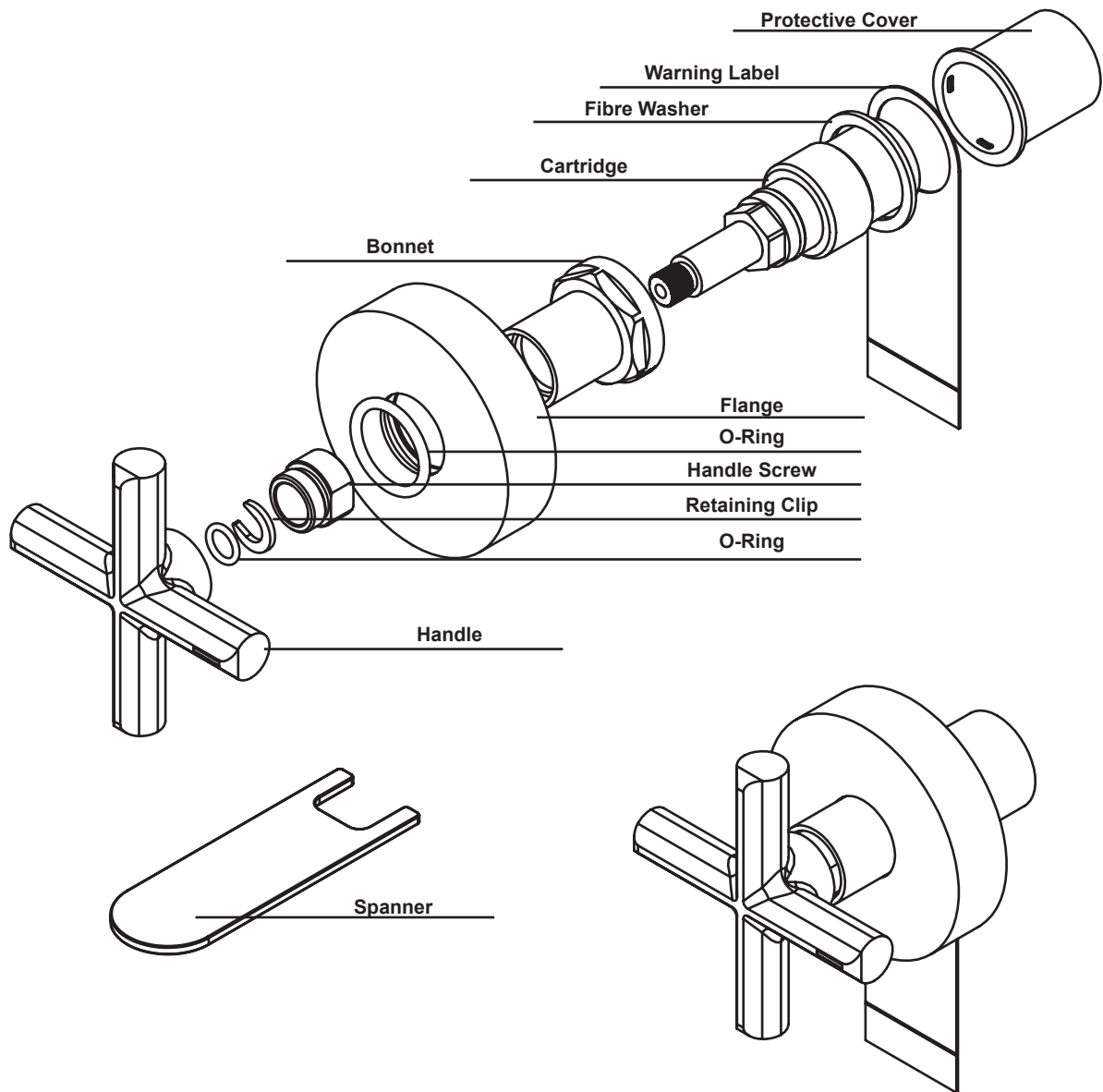

## INSTALLATION

**INSTALLATION COMPLIANCE:** Galvin Engineering products must be installed in accordance with these installation instructions and in accordance with AS/NZS 3500, the PCA and your local regulatory requirements. Water and/or electrical supply conditions must also comply to the applicable nation and/or state standards. Failing to comply with these provisions shall void the product warranty and may affect the performance of the product.

**Adjustment**  
0-12mm

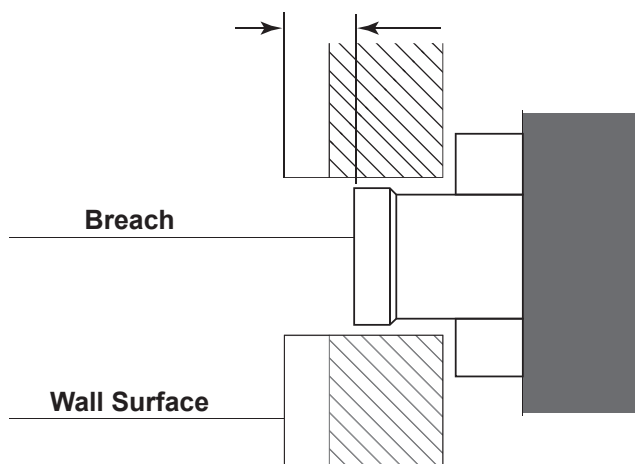

## 1. Adjustment

Ensure that seats in the Breach are in good condition and are free of foreign objects.

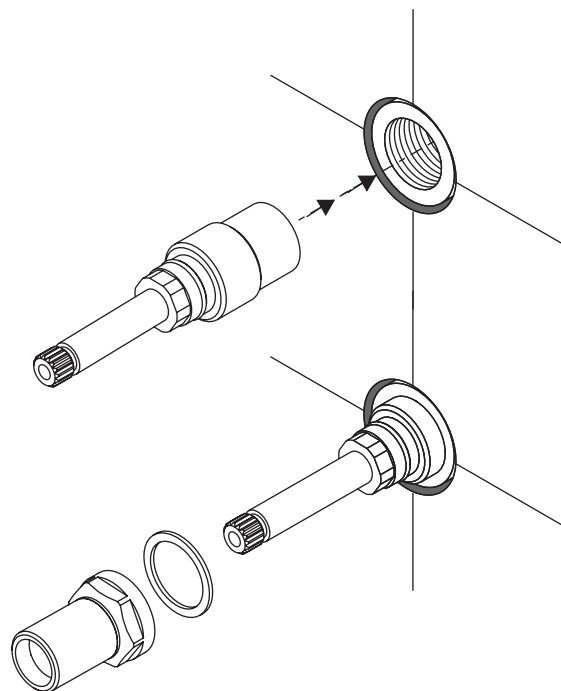

## 2. Cartridge Install

Screw Cartridge into Breach. Tighten Cartridge firmly with a spanner.  
Fit Fibre Washer around the Cartridge and then firmly fasten the Bonnet onto the Spindle using a spanner.

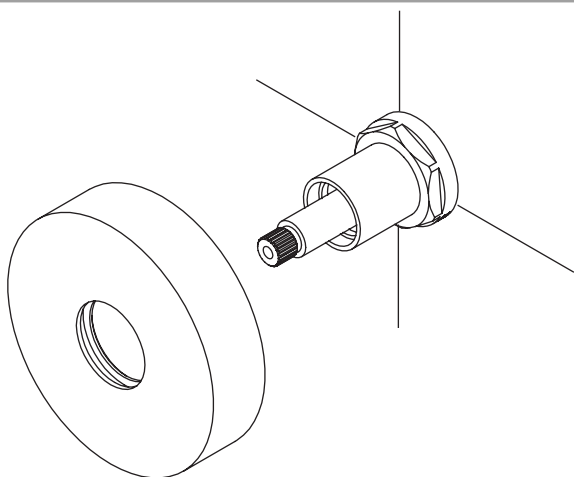

## 3. Dress Plate

Ensure that both Taps are in the closed position.

Push flange onto Bonnet until edge is in contact with tiles.

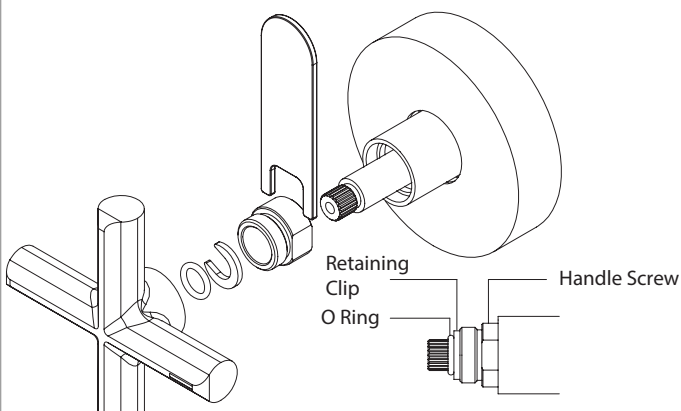

## 4. Handle Install

Place handle screw onto Cartridge shaft with thread facing handle. Press Retaining Clip into Cartridge shaft groove.  
Fit small O Ring over the spline and push up against the Retaining Clip.

- Fit the Handle onto the Spindle.
- Fasten the Handle Screw to the Spindle, using the Spanner provided.

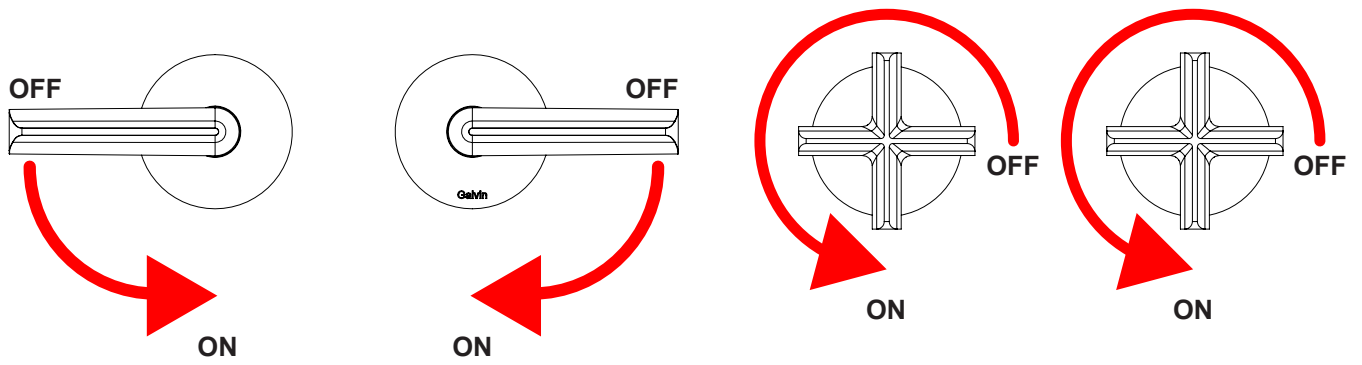

## REMOVE & INSPECT CARTRIDGE

1.
  - Remove Bonnet and Fiber Washer
  - Remove Cartridge, clean and check for damage
  - Reverse previous steps to reinstall

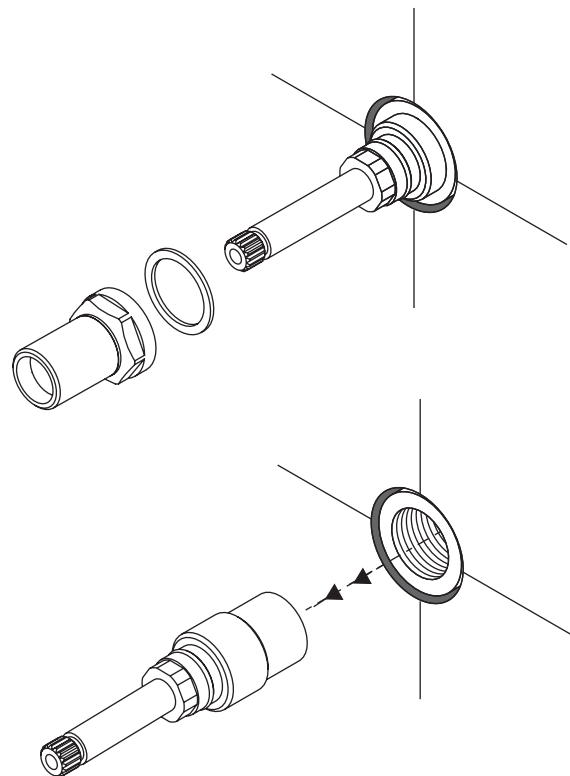

**TROUBLESHOOTING**

PROBLEM	CAUSE	RECTIFICATION
Leaking	Cartridge damaged	Remove and inspect the cartridge, remove debris and/or replace if damaged
	Incorrectly installed	
Inconsistent flow	Blocked flow regulator	Follow the instructions above to remove flow regulator from the body and check for debris. Install an inline strainer to stop further blockages.

**WARRANTY**

Galvin Engineering products are covered under our Manufacturer's Warranty. Galvin Engineering products must be installed in accordance with the installation instructions and in accordance with AS 3500 and NCC Volume Three, relevant Australian Standards and local authorities applicable to product being installed. Water and electrical supply conditions must also comply to the applicable national and/or state standards, failing to comply with these provisions may void the product warranty and affect performance of the product.

Please visit [www.galvinengineering.com.au](http://www.galvinengineering.com.au) to view the full warranty, our Installation Compliance and Maintenance & Cleaning information as well as any other additional information.